

A photograph of three dogs sitting in a dog park. On the left is a German Shepherd with its ears perked up. In the middle is a Golden Retriever with its mouth slightly open. On the right is a large, curly-haired dog, possibly a Poodle or a similar breed. The background shows a wooden fence and some foliage.

**IVGID Board of Trustees Meeting 07/26/23
Incline Village/Crystal Bay
Community Dog Park**

A proposed Village Green dog park configuration

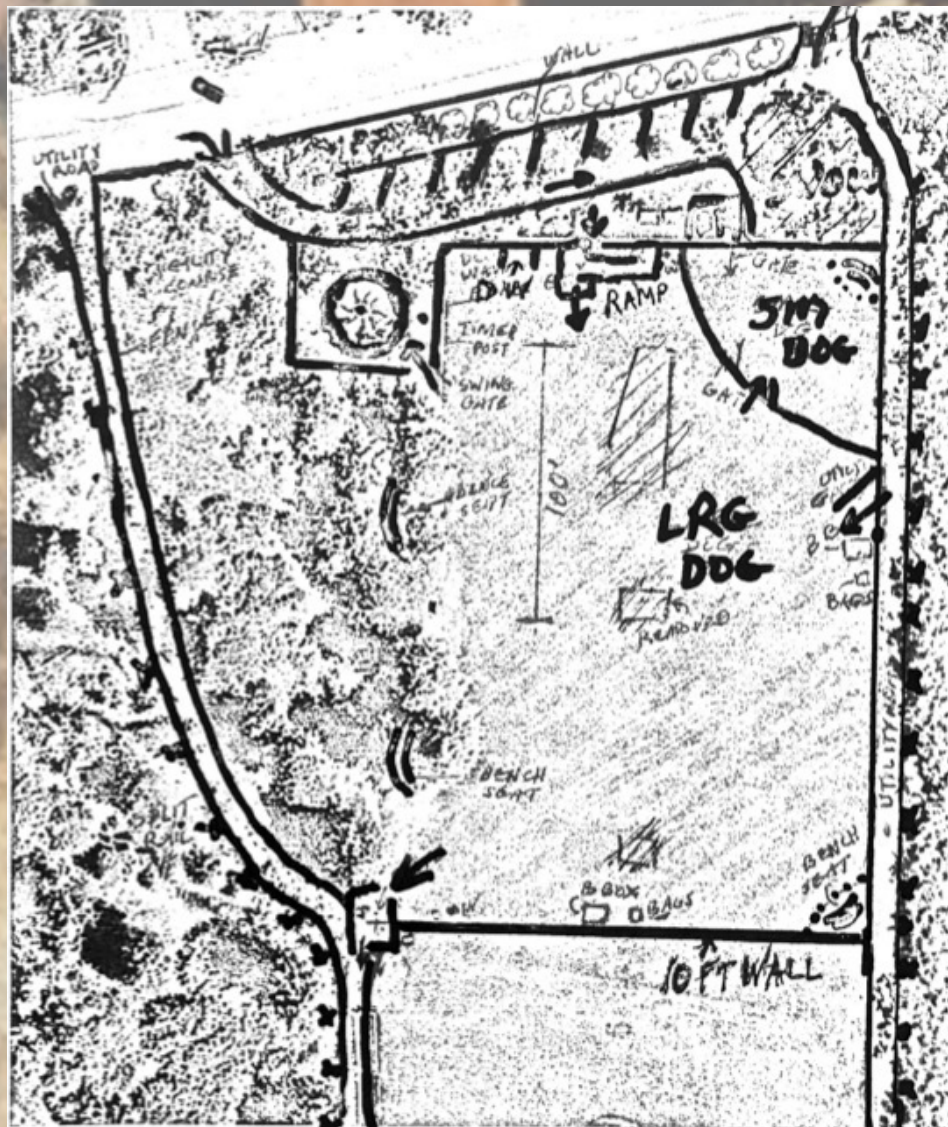

Proposed expansion area

gis.washoecounty.us/wrms/?apn=127-030-15&lat=39.24241254809725&lon=-119.94338217617795&scale=2256.994353&showmarker=false

WASHOE
Regional Mapping System

Home Basemaps Locations Scene

Layers and Tools

Map Layers

Tools

Measure Draw Select

Measure by: [Area] [Perimeter] [Length]

Unit: Square feet (US)

Area: 79,907.50 ft²

Perimeter: 1,284.59 ft

New measurement

My Saved Locations

Quick Maps and Themes

960 LAKESHORE BLVD

APN: 127-010-07

Documents Tax Information

Permit/Acela Information Found (130)

Owner: INCLINE VILLAGE GENERAL IMPROVEMENT DIST

Corporate Area: WASHOE

Zip Code: 89451 Zip City: INCLINE VILLAGE

Tax District: 5200

Voter Precinct: 8107

Land use: 440

Land Zoning: TA_IVT

Utility: Water: Municipal, Sewer: Municipal

Square Ft.: 1535

Acreage: 17.830

Total Assessment: 714085

Bedrooms: 0

Baths: 0

Year Built: 1989

Subdivision: Not Available

Neighborhood: TAYY

Check Parcel to Fire Station Distance (5 miles)

79,907.50 ft²

INCLINE WAY

127-010-07

127-530-13

127-540-08

127-520-17

127-530-19

127-540-03

127-530-08

127-540-11

127-530-24

0 200 ft

lat: 39.24322 lon: -119.94468 s: 2257

Next Steps

- **Meet with TRPA to discuss setback and use of area to the west of Village Green upper and lower fields.**
- **Develop conceptual plan (with cost estimate) that fits into the hopefully enlarged space**
- **Seek board and community input.**
- **Develop full packet for submittal to TRPA/Washoe County**
- **Solicit donations, depending on project scope.**
- **Target start date: spring 2024.**